

Erasmus
School of
Economics

ESWM 2019

European Winter Meeting of the
Econometric Society

15 - 17 December 2019

Rotterdam, the Netherlands

ES
Society
Econometric

Erasmus University Rotterdam
Make it happen.

Erasmus

Welcome!

Dear congress members,

A warm welcome to Rotterdam, the place where it all started!

It is about 50 years ago that the book "Principles of Econometrics" appeared, authored by the Rotterdam-based econometrician Henri Theil. Moreover, the Econometric Society was founded in 1933 by Ragnar Frisch and the Rotterdam-based Jan Tinbergen. They both were awarded the first Nobel Prize in Economics exactly half a century ago, in 1969.

Today, the Rotterdam Econometric Institute of Erasmus School of Economics (founded by Jan Tinbergen and Henri Theil in 1956) is home to more than 1000 bachelor and master students in Econometrics and Operations Research, and also to two Fellows of the Econometric Society, Professor Teun Kloek and Professor Peter Wakker.

I wish you all very pleasant and successful days!

Philip Hans Franses
Erasmus School of Economics

ESWM 2019 takes place at Campus Woudestein



Legend

- | | | | |
|--|--------------|--|---------------|
| | Bus | | Tennis Courts |
| | Metro | | Library |
| | Tram | | Food & Drinks |
| | Parking | | Shops |
| | Pay Station | | Graduations |
| | Sport Centre | | |

Public transportation

RET is the independent public transport company. With the trams or subway of the RET, you can travel to the campus. From Rotterdam Central Station:

Tram 7, direction Woudestein

Stop 'Erasmus Universiteit'.

Tram 21 or 24 direction De Esch

Stop 'Woudestein'.

Metro, direction Slinge

Transfer at Beurs, to subway in the direction of Binnenhof, Nesselande or De Terp. Get off the subway at station Kralingse Zoom. This metro station is within walking distance (10 minutes) of the campus.

Route description car

The Woudestein campus is situated near the A16 and easily accessible by car.

On the A16, from both directions, take exit 25 (Centrum). Follow the signs 'Centrum'. Turn right at the traffic lights (Burgemeester Oudlaan). You will find the Woudestein campus on the right-hand side.

Erasmus University Rotterdam Campus Woudestein

Van der Goot building
(Erasmus Expo and Conference Centre)
Burgemeester Oudlaan 50
3062 PA Rotterdam
The Netherlands

How to walk to the congress dinner venue



When you leave Van der Goot building, turn left. Walk about 50 meters on "Thomas Morelaan" in western direction.

Turn to the left in the direction of "Abram van Rijckevorselweg/S107" for 100 meters.

Turn right to "Abram van Rijckevorselweg/S107" and follow 220 meters. Follow the road to the right to "Honingerdijk" and follow for 200 meters.

Turn right to remain on "Honingerdijk" and follow for about 90 meters.

Turn to the right.

You have reached the dinner venue, "Excelsior Van Donge & De Roo Stadion", Honingerdijk, Rotterdam.

Floor plans congress venue - Van der Goot building

First floor

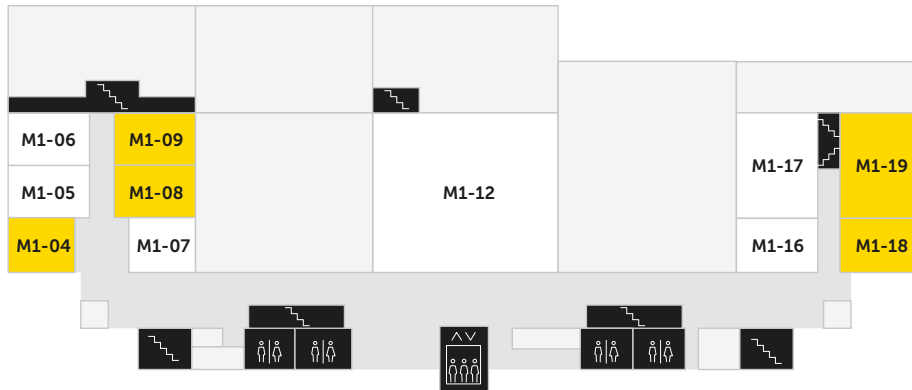

Second floor



Session rooms

M1-04 Montreal
M1-08 Leuven
M1-09 Bergen
M1-18 Lund
M1-19 Athene

M2-06 Galway
M2-07 Basel
M2-11 Santander

M3-03 Aberdeen
M3-04 Auckland
M3-05 Praag
M3-09 Restaurant
M3-11 Restaurant
M3-15 Forumzaal

Registration desk

The registration desk is located on the 3rd floor in the Van der Goot building (Erasmus Expo and Conference Centre).

Opening hours:

16 December 08.00-19.00 hrs
 17 December 08.00-19.00 hrs

WiFi

Wifi: **eduroam**
 username: **aayki@edu.nl**
 password: **xpuet**

Third floor

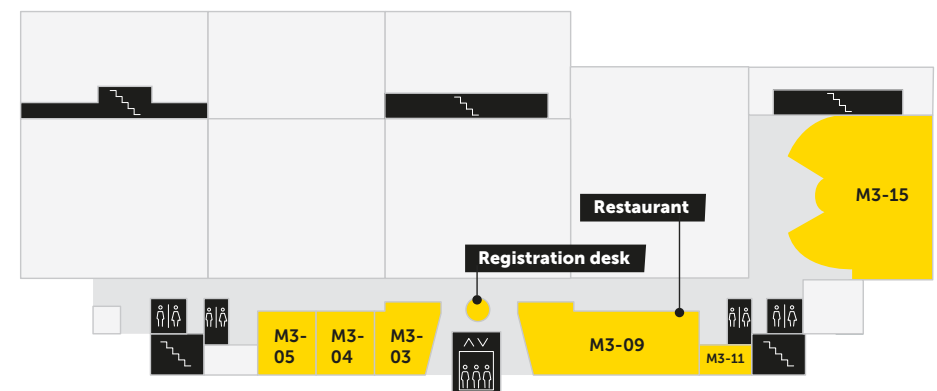

Social events

15 December 2019 Welcome reception

15.00-17.00 hrs

Location: Erasmus University Campus,
ground floor E-Building

16 December 2019 Congress dinner

19.00-23.00 hrs

Location: Excelsior, Van Donge &
De Roo stadion (Soccer stadium)
Honingerdijk, Rotterdam
450 metres from Congress venue

Programme overview:

15 December

15:00 - 17:00

Welcome reception

16 December

08:00 - 09:00

Registration and Welcome

09:00 - 11:00

9 Parallel Sessions

11:00 - 11:30

Coffee break

11:30 - 12:45

Plenary Lecture:
Giovanni L. Violante

12:45 - 14:00

Lunch break

14:00 - 16:00

9 Parallel Sessions

16:00 - 16:30

Coffee break

16:30 - 18:30

9 Parallel Sessions

19.00 - 23.00

Congress dinner

17 December

09:00 - 11:00

9 Parallel Sessions

11:00 - 11:30

Coffee break

11:30 - 12:45

Plenary Lecture:
Stéphane Bonhomme

12:45 - 14:00

Lunch break

14:00 - 16:00

9 Parallel Sessions

16:00 - 16:30

Coffee break

16:30 - 18:30

9 Parallel Sessions

Summery of all events

16 December 2019

Time	Location	Title	Organizer
9:00-11:00	Forumzaal (M3-15)	Decision theory	Vasiliki Skreta
	Athene (M1-19)	Discrimination, Trust and Prosocial Behavior	Teodora Boneva
	Lund (M1-18)	Effects of Networks	Eleonora Patacchini
	Aberdeen (M3-03)	Growth and Development I	Ingvild Almås
	Auckland (M3-04)	Labor economics	Libertad González
	Bergen (M1-09)	Macroeconomics across sectors and borders	Manuel García-Santana
	Praag (M3-05)	Microeconometrics I	Xavier d'Haultfoeuille
	Santander (M2-11)	Risk and Return Factors	Pierre Collin-Dufresne
	Leuven (M1-08)	Uncertainty and the Macroeconomy	Vincent Sterk
11:30 - 12:45	Forumzaal (M3-15)	Plenary Lecture by Giovanni L. Violante "Household Balance Sheet Channels of Monetary Policy"	Claudio Michelacci
14:00-16:00	Aberdeen (M3-03)	Aggregate Labor Markets I	Antonella Trigari
	Praag (M3-05)	Applied Micro Labour Focus	Mirko Draca
	Leuven (M1-08)	Credit, Risk, and Investment	Julien Sauvagnat
	Forumzaal (M3-15)	Demand & Pricing	Andrea Pozzi
	Auckland (M3-04)	Demographic Economics	David de la Croix
	Athene (M1-19)	Macro dynamics with financial frictions	Luigi Paciello
	Bergen (M1-09)	Macro Public Finance	Facundo Piguillem
	Santander (M2-11)	Microeconometrics II	Toru Kitagawa
	Lund (M1-18)	Topics in Inequality and Macro	Kurt Mitman

16:30-18:30	Praag (M3-05)	Advances in the Study of Consumption Behavior	
	Aberdeen (M3-03)	Asset Prices and the Macroeconomy	Konrad Burchardi
	Leuven (M1-08)	Communication and Inflation Expectations	Gaetano Galballo
	Lund (M1-18)	Culture and Gender	Eleonora Patacchini
	Bergen (M1-09))	Empirical Political Economy	Stefano Gagliarducci
	Santander (M2-11)	Estimation and Inference on Dependent Data	Toru Kitagawa
	Auckland (M3-04)	Information Economics: Empirics	Philipp Schmidt Dengler
	Athene (M1-19)	Mechanisms and games	Daniel Garrett
	Forumzaal (M3-15)	Trade and Resource Allocation	Carolina Villegas Sanchez

17 December 2019

Time	Location	Title	Organizer
9:00-11:00	Basel (M2-07)	Education, Labor and Environmental	Catarina Calsamiglia Costa
	Leuven (M1-08)	Firms and the Macro Economy	Vincent Sterk
	Athene (M1-19)	Games and decisions	Daniel Garrett
	Praag (M3-05)	Macro and financial econometrics	Xavier d'Haultfoeuille
	Bergen (M1-09)	Market Intermediaries and Platforms	Philipp Schmidt Dengler
	Forumzaal (M3-15)	Monetary Policy Transmission	Luigi Paciello
	Galway (M2-06)	Political Economy	Helios Herrera
	Aberdeen (M3-03)	Production Networks and Spatial Dynamic Models	Eleonora Patacchini
	Montreal (M1-04)	Quantitative Macroeconomics	David de la Croix
11:30-12:45	Forumzaal (M3-15)	Plenary Lecture by Stéphane Bonhomme "Two-Sided Heterogeneity in Worker-Firm Linked Data"	Claudio Michelacci
14:00-16:00	Basel (M2-07)	Belief updating and information processing	Lorenz Goette
	Galway (M2-06))	Credit Markets and Productivity	Konrad Burchardi
	Leuven (M1-08))	Empirical Models of Market Structure	Andrea Pozzi
	Aberdeen (M3-03)	Gender and Development	Ingvild Almås

	Montreal (M1-04)	Long Term Risks and Contracts	Pierre Collin-Dufresne
	Bergen (M1-09)	Macroeconomics and Political Economy	Facundo Piguillem
	Forumzaal (M3-15)	Microeconometrics III	Stephane Bonhomme
	Athene (M1-19)	Risk, Exchange Rates and the Transmission Channel	Carolina Villegas Sanchez
	Praag (M3-05)	Unemployment Insurance	Kurt Mitman
16:30-18:30	Aberdeen (M3-03)	Aggregate Labor Markets II	Antonella Trigari
	Athene (M1-19))	Beliefs and Biases in Decision Making	Teodora Boneva
	Galway (M2-06)	Gender and Sex	Libertad González
	Basel (M2-07)	Growth and Development II	Lorenzo Casaburi
	Montreal (M1-04)	Industrial Organisation and Firm-level Analysis	Mirko Draca
	Leuven (M1-08)	Macro Theory and Monetary Economics	Gaetano Galballo
	Forumzaal (M3-15)	Macroeconomics	Luigi Paciello
	Bergen (M1-09)	Micro Theory	Vasiliki Skreta
	Praag (M3-05)	Risk Premia	Julien Sauvagnat

Please consult the Conference maker programme for details regarding the presentations and papers per session.

Contact and info:

eswm2019@congresseventservices.com

eur.nl/en/ese/events/eswm/